

THE MAGAZINE OF SPLENDID HOMES AND GARDENS • JULY/AUGUST 2011

DESIGN

new england

BY THE SEA

Coastal getaways
made for family summers

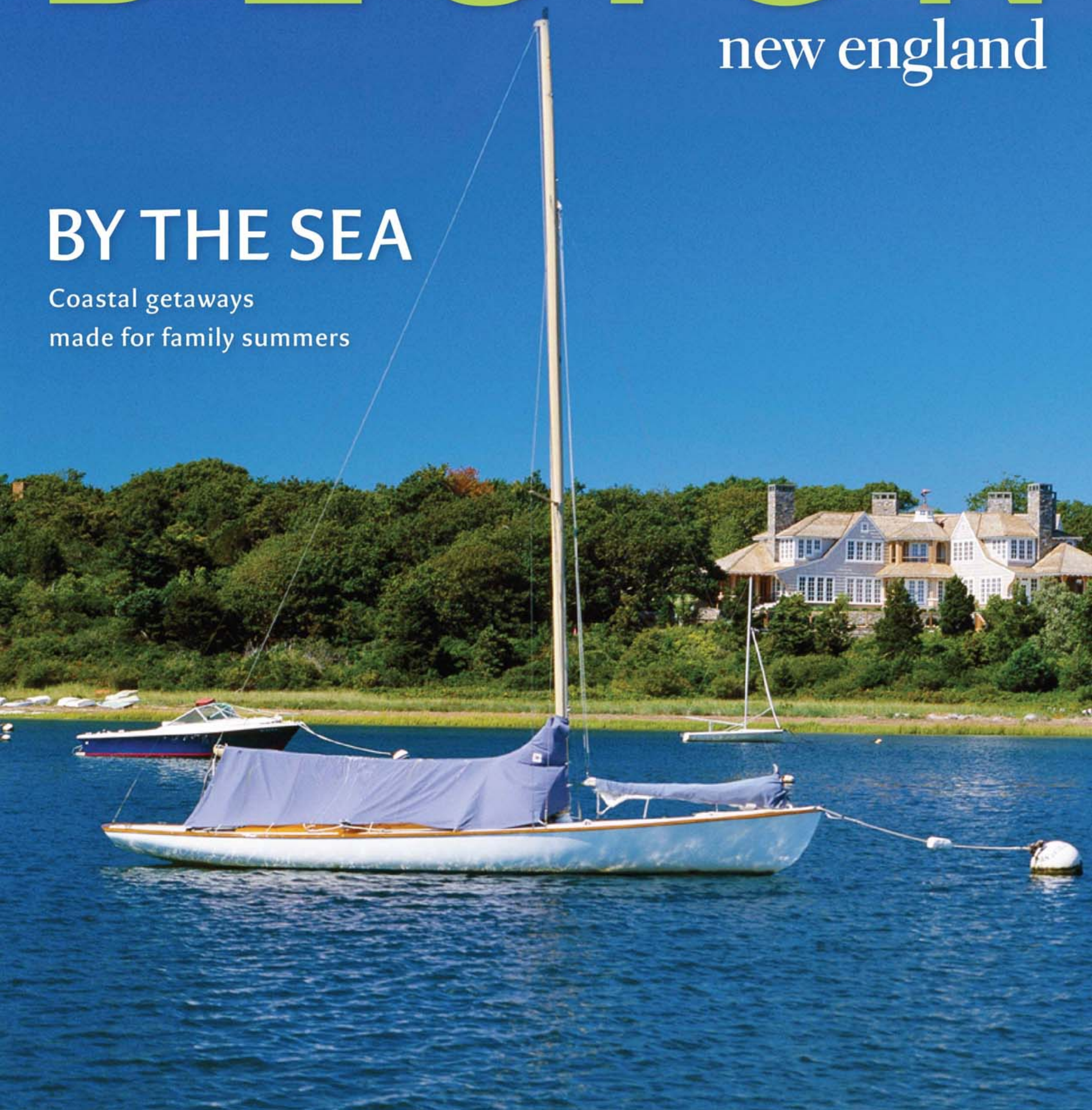

perfect Setting

AT LAST, A CAPE COD VACATION HOUSE WHERE THE OWNERS AND THEIR ICONIC FURNITURE FEEL AT HOME

WRITTEN BY JACI CONRY / PHOTOGRAPHED BY BRIAN VANDEN BRINK

THE VIEW FROM the master bedroom is a dramatic vista of the property. The landscape terraces down from the porch below into an upper backyard, a lower yard including the pool, the natural coastal bank, and the beach and harbor's edge.





Burton Staniar

SUMMERS ON CAPE COD, AND ALWAYS HAS. "WE'VE OWNED AND RENTED IN VARIOUS LOCATIONS," HE SAYS, "BUT THE HOUSES WERE ALWAYS LACKING IN SOME WAY." UNTIL NOW, THAT IS. WORKING WITH ARCHITECT JOHN DASILVA

of Polhemus Savery DaSilva Architects Builders in Chatham, Massachusetts, Staniar and his wife, Nancy, have created a getaway custom-designed to suit them, their art, and their classic pieces from Knoll, the iconic manufacturer of modern furniture where Burton is chairman of the board and former CEO.

Set far back from the road, the Staniar's lot is a large, verdant site on Stage Harbor with majestic views of Nantucket Sound. "We fell in love with the location immediately, and that was that," says Burton. Dream location secured, "we wanted the house to seem as though it had always been there."

The couple engaged DaSilva to design that house, one that would provide both a comfortable venue for an eclectic mix of art and furnishings and a place where the couple, who live year-round

in New York City, could entertain a large crowd.

The Staniar's were drawn to the architecture of traditional English country houses, and DaSilva sought inspiration from British architect CFA Voysey. To make the house compatible with the coastal Cape Cod setting, staple elements of 19th-century Shingle Style (extensive porches, eaves, and gables) were included in the design.

The front of the house acts as a formal backdrop for an expansive landscape crafted by David Hawk of Hawk Design of Boston and Orleans, Massachusetts, replete with informal gardens, a wildflower meadow, and lush grass, which the architect and homeowners refer to as the "park." The back of the house faces the water for stunning views. To take full advantage of the setting, DaSilva conceived a

.....
**ARCHITECTURE +
 CONSTRUCTION**
 POLHEMUS
 SAVERY DASILVA
 ARCHITECTS
 BUILDERS



MIES VAN DER ROHE
 Tubular Brno chairs are paired with a custom-made table in the dining area (FACING PAGE), which is separated from the living room by several steps. The two-story entry features a gracious staircase, oak floors stained walnut, and Louis Poulsen pendant lights.

layout in which two wings are at 45-degree angles to a rectangular center. “This plan maximizes a site that has harbor views wrapping partly around it,” says DaSilva. “The wings capture direct sunlight at ideal times of day for the home’s different spaces — eastern light for the kitchen, western light for the living room.”

“We wanted the ocean to be visible as soon as one stepped through the front door,” says Nancy Staniar. To accomplish that, DaSilva placed French doors framing the view at the end of the long, gracious entry hall.

To allow for uninterrupted water views and to enhance the sense of one large continuous space, there are no walls separating rooms on the first floor. Living, kitchen, and dining areas all flow into one another. “The different rooms are defined by ceiling soffits and shapes, light coves, and archways,” says DaSilva. “The spaces have just enough definition so they are comfortable as separate areas, but they are wide open to each other in terms of circulation, passage, and

social interaction. The house works very well for entertaining.”

Nancy, an interior designer, tailored the home to be relaxed yet lively with some collaboration from colleague Eric Cohler of Eric Cohler Design in New York City. Clean-lined furniture is combined with a range of art. Among the collection are many paintings by Cape Cod artists, whimsical African pieces, and contemporary photography. Midcentury furnishings are paired with antiques: In the entryway, weathered, dusty red painted 17th-century chests stand in contrast to Louis Poulsen artichoke pendant lamps (icons of modern Scandinavian design) that illuminate the space with dramatic impact. “The juxtaposition of very different eras and styles adds fun and interest,” says Nancy.

The kitchen is outfitted with Bertioia barstools — fashioned out of metal rods and manufactured by Knoll since 1952 — that complement the sleek, minimal SieMatic cabinets painted a custom high-gloss gray. The room is refined and understated: Appliances are



DESIGN DECISION

At Home With Iconic Knoll (still in production today)

TUBULAR BRNO CHAIR
Ludwig Mies van der Rohe, for the Tugendhat house in Brno, Czech Republic, 1930. “Architecture is a language; when you are very good you can be a poet.”



BERTOIA BARSTOOL
Harry Bertioia, 1952. “If you look at the chairs, they are mainly made of air, like sculpture. Space passes through them.”



SAARINEN EXECUTIVE CHAIR
Eero Saarinen, 1957. “Always design a thing by considering it in its next larger context — a chair in a room, a room in a house, a house in an environment . . .”



THICK MARBLE tops the SieMatic cabinetry, which is painted a high-gloss custom gray that reflects light and the harbor view. With floor-to-ceiling bookshelves on all four walls, the library (FACING PAGE) is designed to be cozy, a place to hunker down during the winter.



integrated with the cabinetry, and the warm neutral tones in the white marble countertops are matched in the upholstery of the midcentury Eero Saarinen Executive Side Chairs around the kitchen table.

The Staniers' children and grandchildren visit often. A big hit with the kids is a loft fashioned in the shape of a bright blue boat hull in one of the guest bedrooms. "We even find some of the adults up there occasionally," says Burton. While the house is frequently filled with guests, it's also a retreat, where the husband and wife relish spending time together. The library, the sole room that doesn't have an ocean view, is one such spot congenial

for a party of two. With coffered ceilings and floor-to-ceiling bookshelves, the room is furnished with a glass Mies van der Rohe coffee table and a Florence Knoll lounge sofa. "It's a very cozy space," says Nancy. "We love to be in here during the winter months." In the summer, the couple pass much of their time on the porch off the living room, which has prime sunset views and a wood-burning fireplace.

"After spending years in houses that weren't quite right, we decided to try to build the perfect place for us," says Burton. "And we think that's exactly what we've done." ▲

FOR MORE
DETAILS,
SEE
RESOURCES



THE SUNSET VIEWS from the porch and adjacent terrace off the living room make them prime spots for evening entertaining. At the end of the grand entry hall is a secondary hall (FACING PAGE) where French doors frame the landscape. The ceiling is painted a creamy gold, a backdrop for a Louis Poulsen chandelier. The living and dining areas are to the left; the kitchen is to the right.

First Floor

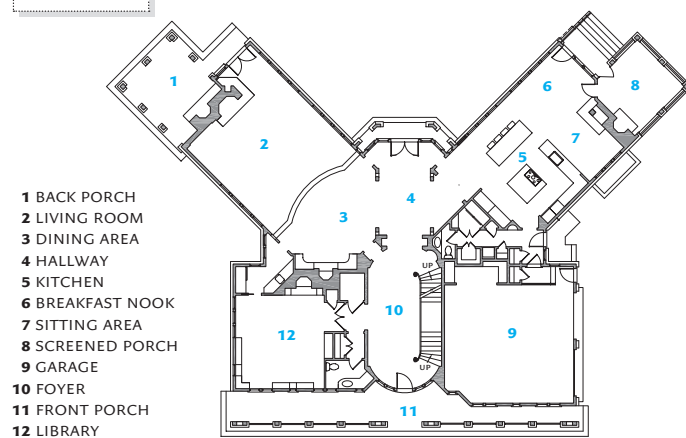

Second Floor

